

Package Contents

- ORTO™**
- (A) Reservoir
 - (B) Aerator
 - (C) Planting Tray
 - (D) Mini Planters
 - (E) Water Level Indicator
- Accessories**
- (F) Bio Char Media
 - (G) 12VDC/5A Power Adapter
 - (H) ORTO™ Instructions



Product Specifications

Product Name	ORTO™
Model	HB-001 M3
Control System	Smart Timer (Automatic)
Light Source Type	UV LED
Planting Capacity	14 Mini Planters
Volume Capacity	6.1L (1.6 US gal) Water 31L (1882 cu in) Grow Space
Power Supply	AC 100~240V, DC 12V/5A
Power Consumption	35W
Material	PP, ABS, AL
Weight	9.2Kg (20 lb)
Dimensions	(L)446 x (W)346 x (H)417 mm (L)17.6 x (W)13.6 x (H)16.4 in

Locate ORTO™



Connect Power



Add Water Level Indicator

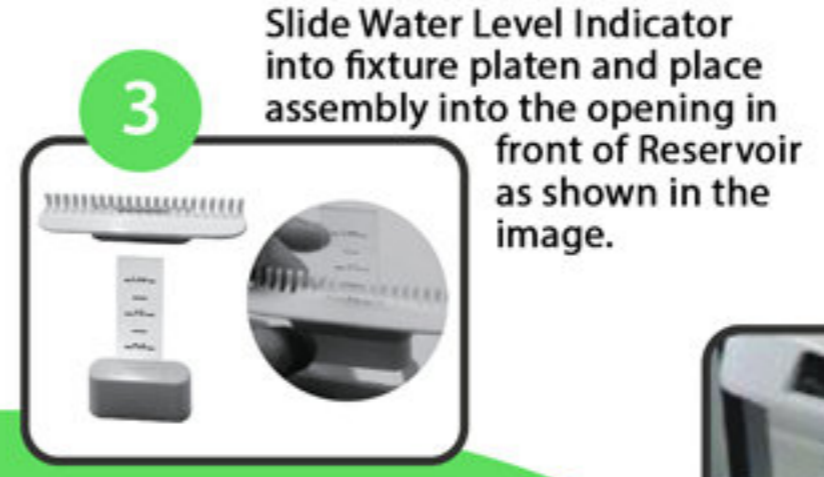

Add Water



Add Nutrients

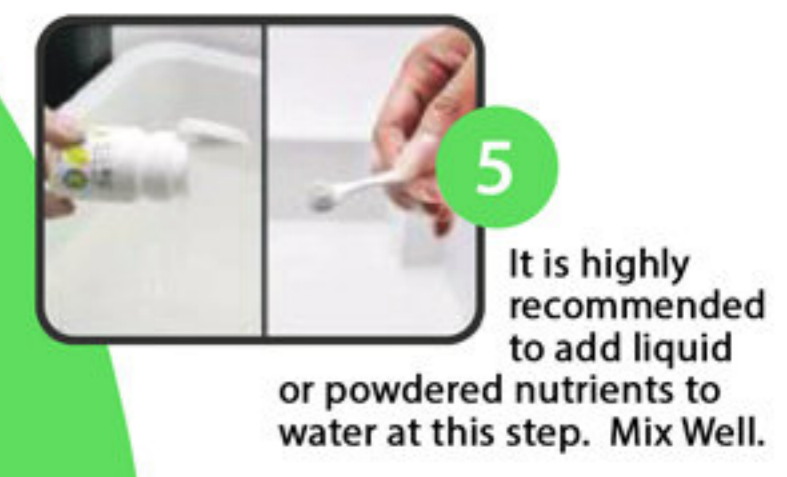

Insert Tray



Insert Seeds



Press Grow



Cultivate

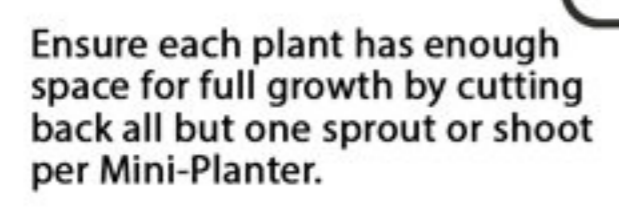

Irrigate

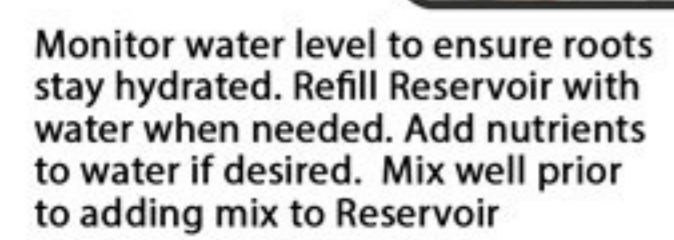

Harvest



Cleanup

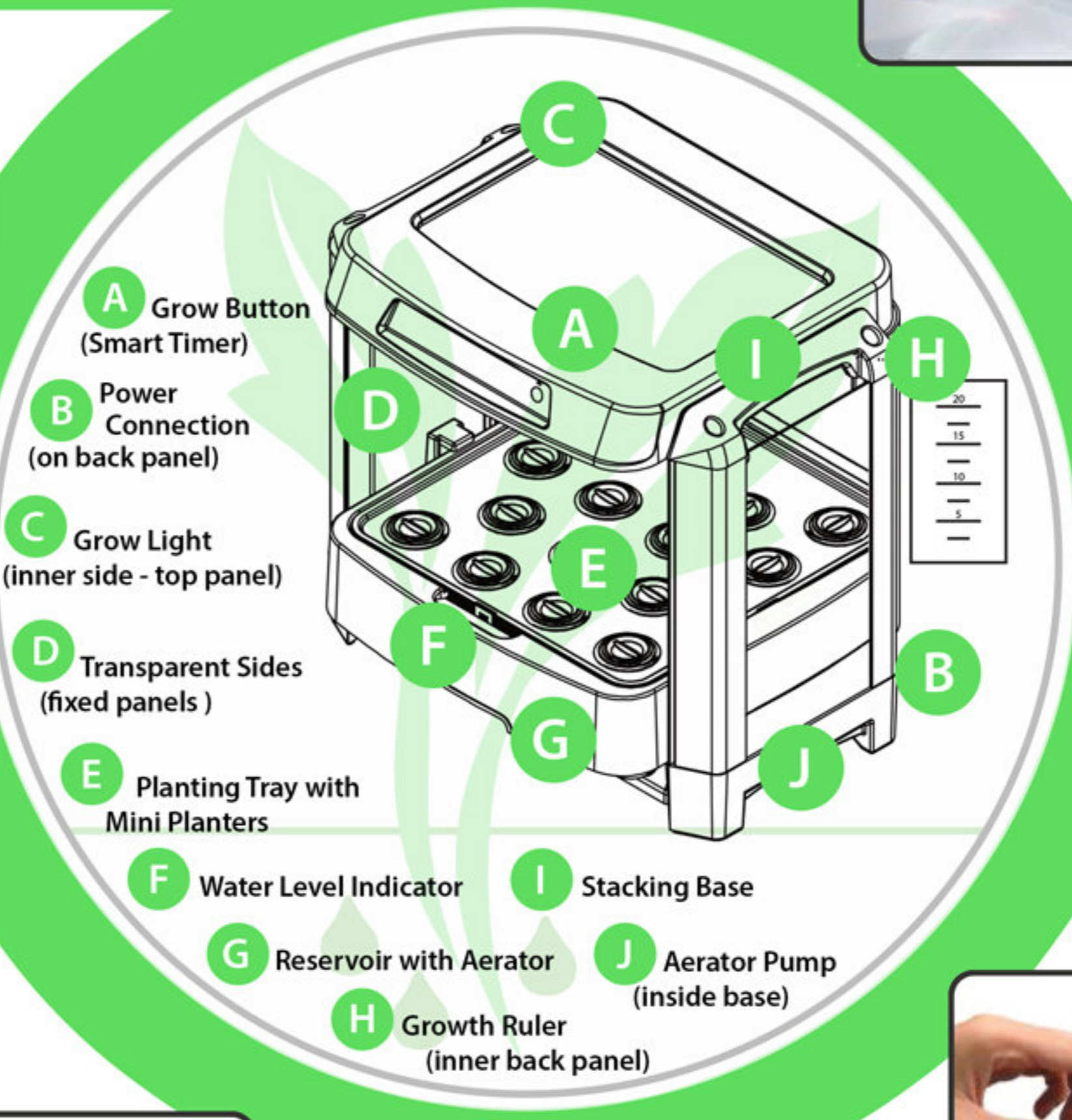
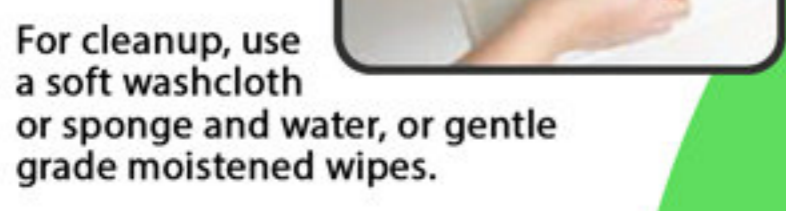

Caution:

- WARNING: To reduce the risk of electric shock, do not open ORTO™. No user serviceable parts inside.
- WARNING: Disassembly, modification or any attempt at repair could cause damage to ORTO™ and even bodily injury or property damage, and will void any warranty.
- Keep AC/DC Adapter dry and away from water.
- Avoid using ORTO™ when the power cord or plug is damaged or loose.
- Avoid using the AC/DC Adapter if it or the power cord has become damaged.
- Replace the AC/DC Adapter and or power cord if it becomes damaged or exposed to excess moisture.
- If ORTO™ is not used for long periods, the AC/DC Adapter should be unplugged from power outlet.
- Always locate ORTO™ on a solid support surface that has adequate strength to support the weight of ORTO™ with a full reservoir.
- Do not tilt ORTO™ forward, rearward, or sway ORTO™ when it is setup and running.
- Ensure adequate water supply in the reservoir and that Aerator is fully submerged and functioning at time of setup and during grow cycle.

Smart Timer setup



Press and hold Grow button for 3 seconds. The Grow light will flash to indicate system has been started and will run in Auto mode. Once started, ORTO™ Smart Timer, routinely cycles ORTO™ through a lighting mode process (green light) for 16 hours then switches to Sleep mode for 8 hours (yellow light), and repeats the process daily. The ORTO™ Smart Timer should be reset after a power outage.

NOTE: At times ORTO™ may produce a small amount of noise while the Aerator pump is operating; typically lasting for 10 minutes each time.



WWW.LIBURDII.COM

ORTO™

LIBURDI INDUSTRIES